

Notch Offset "X"	Morton Part Number
6-3/4"	102-219B
7"	102-172B
8-7/8"	102-222B
10-1/4"	102-094B
10-1/2"	102-003B
10-3/4"	102-217B
11"	102-106B
11-1/4"	102-234B
11-7/8"	102-220B

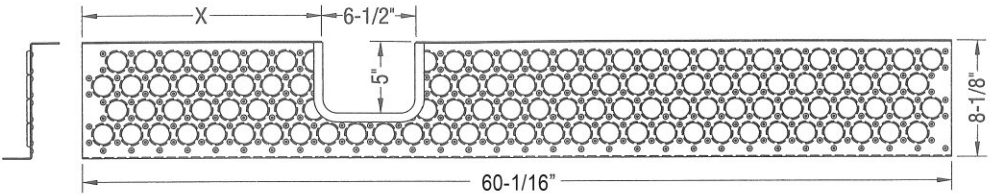

“B” END, OPEN BACK END PLATFORM WITH COLLAR

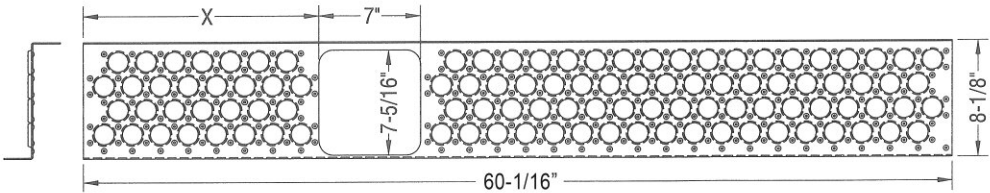

“B” END, CLOSED BACK END PLATFORM

*Special Order

Morton Part Number
102-046A

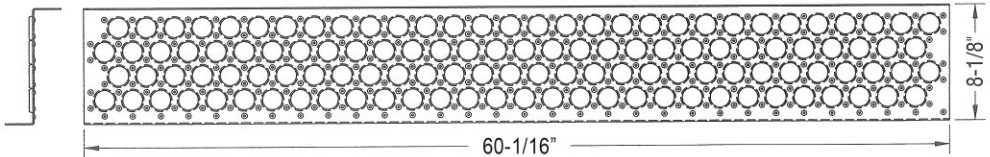

“A” END – END PLATFORM

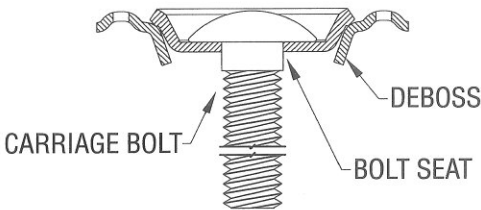

TYPICAL INSTALLATION

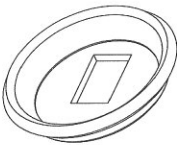

1/2" BOLT SEAT

Morton Part Number: 701-214

Tolerances for dimensions above are ±1/16". Standard lengths are 60-1/16", and made from 13 ga. pre-galvanized steel, (.086" thick). Standard notches are 6-1/2" x 5", and cutouts are special order 7" x 7-5/16". Custom lengths, widths, heights, materials, and tread pattern locations are also available.

OPEN-GRIP® BRAKE STEPS



Notch Offset "X"	Morton Part Number
5-3/8"	101-390
6-1/8"	101-053
7"	101-061
8"	101-288
9-3/4"	101-209
10"	101-015
10-9/32"	101-221
11-1/4"	101-387
12-5/8"	101-163

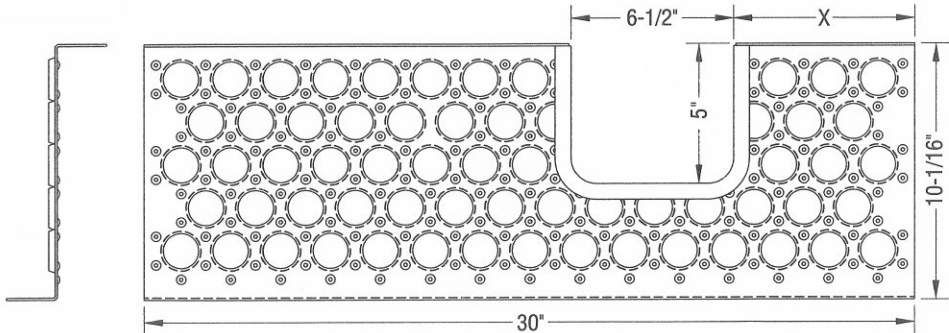

OPEN BACK BRAKE STEP WITH COLLAR

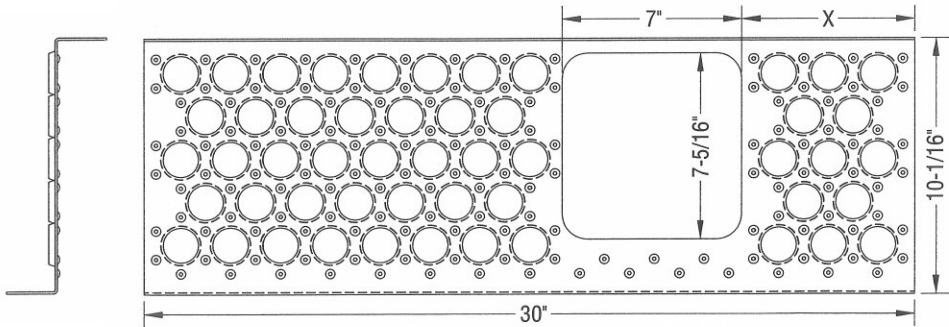

CLOSED BACK BRAKE STEP *Special Order

Morton Part Number
101-078

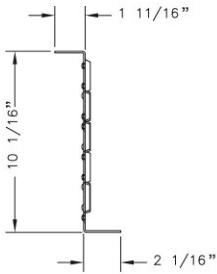
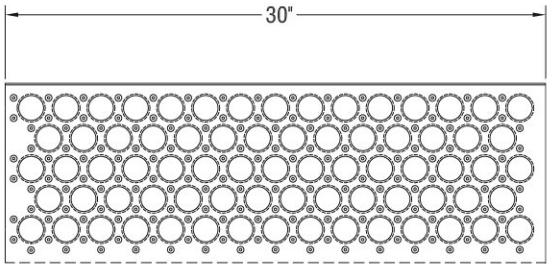

"A" END – BRAKE STEP

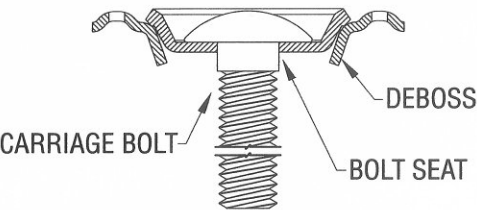

TYPICAL INSTALLATION

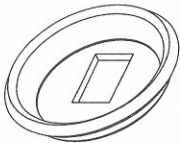

1/2" BOLT SEAT

Morton Part Number: 701-214

Tolerances for dimensions above are $\pm 1/16"$. Standard lengths are 30", and made from 13 ga. pre-galvanized steel, (.086" thick). Standard notches are 6-1/2" x 5", and cutouts are special order 7" x 7-5/16". Custom lengths, widths, heights, materials, and tread pattern locations are also available.

END PLATFORM INQUIRY FORM

Morton
MANUFACTURING COMPANY

Your Name: _____

Ship To: _____

Company: _____

Phone Number: _____

Fax Number: _____

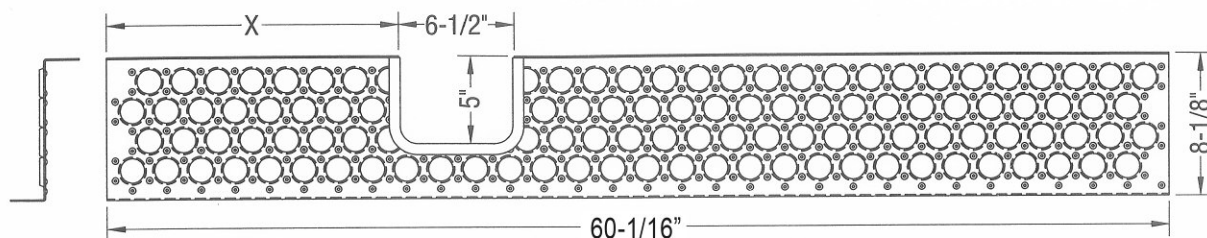

“B” END, OPEN BACK END PLATFORM WITH COLLAR

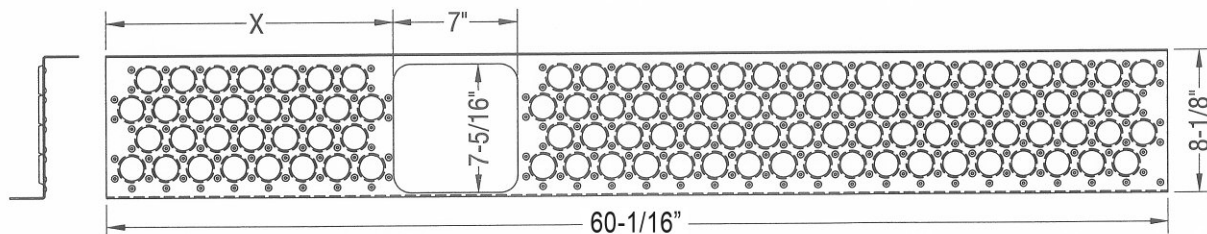

“B” END, CLOSED BACK END PLATFORM *Special Order

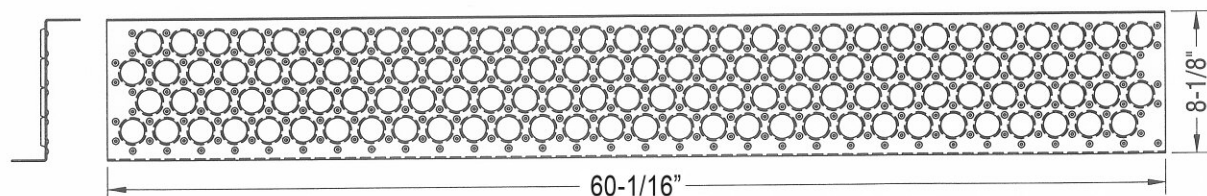

“A” END - END PLATFORM

Fax Drawing to:
Morton Manufacturing Company
(847) 362-5434 Fax
(847) 362-5400 Phone
(877) 667-8634

STEP TYPE

HOLE (X) LOCATION

QUANTITY

☐ Open Back

_____ in.

☐ Closed Back

_____ in.

☐ “A” End

BRAKE STEP INQUIRY FORM



Your Name: _____

Ship To: _____

Company: _____

Phone Number: _____

Fax Number: _____

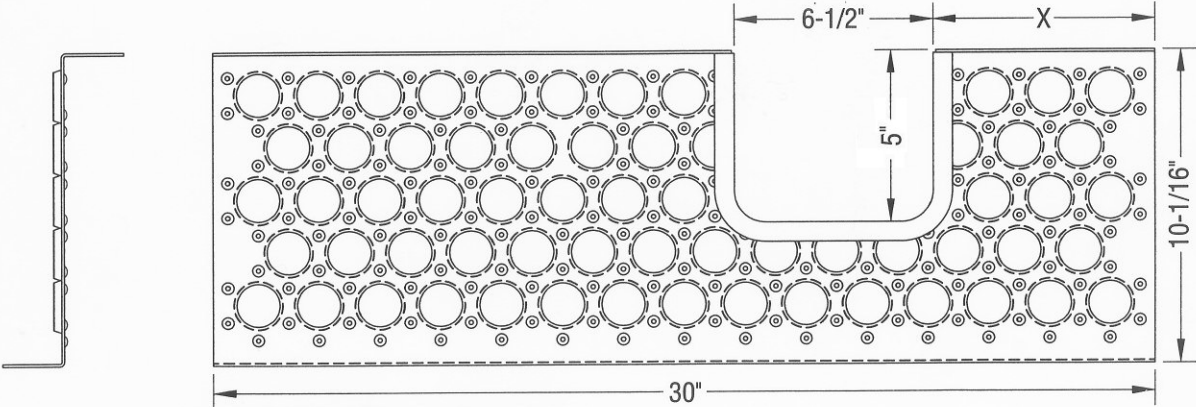

OPEN BACK BRAKE STEP WITH COLLAR

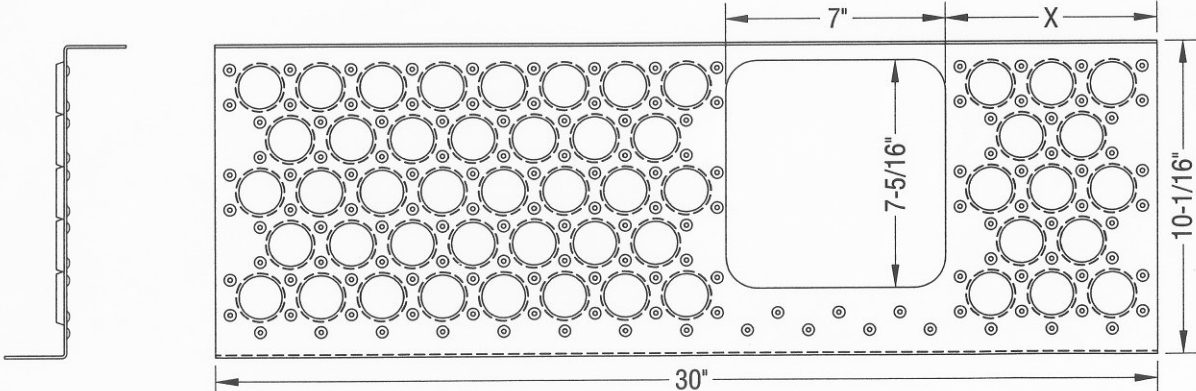

CLOSED BACK BRAKE STEP *Special Order

Fax Drawing to:
Morton Manufacturing Company
(847) 362-5434 Fax
(847) 362-5400 Phone
(877) 667-8634

STEP TYPE	HOLE (X) LOCATION	QUANTITY
<input type="checkbox"/> Open Back	_____ in.	_____
<input type="checkbox"/> Closed Back	_____ in.	_____
<input type="checkbox"/> "A" End		_____

OPEN-GRIP® RUNNING BOARDS

Morton
MANUFACTURING COMPANY

OPEN GRIP® ALL-PURPOSE 24" WIDE RUNNING BOARDS

Morton Part Number: 704898-1 Standard Profile: 1-15/16" height
708437 Low Profile: 1-17/32" height

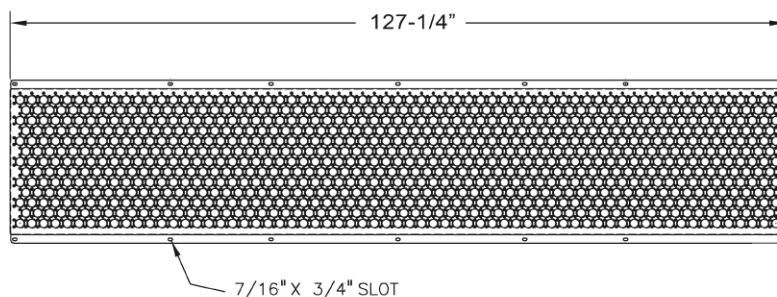

Standard Profile 1-15/16"
or
Low Profile 1-17/32"

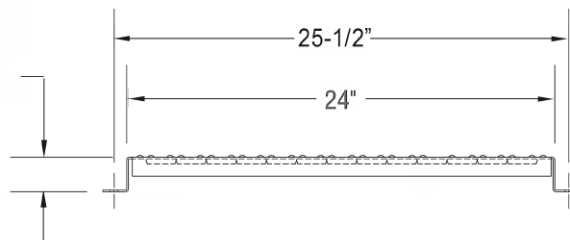

Morton Part Number: 711001
Huck Washer recommended for use in
fastening at bolt hole location

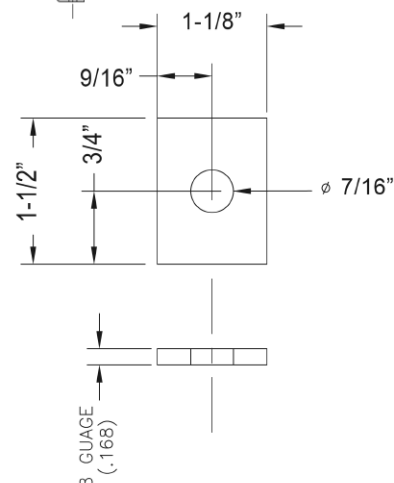

Running Board tolerances are $\pm 1/16"$. Manufactured from 13 ga. G90 pre-galvanized steel, (.086" thick).

RRINS5-599